

Soils Map

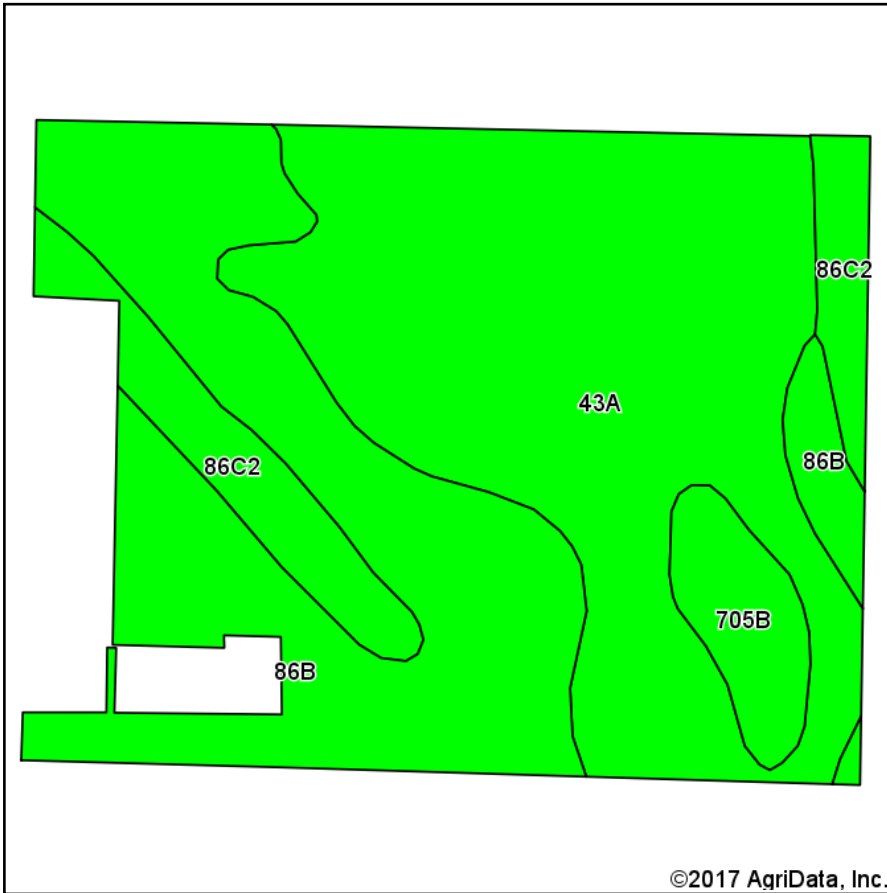

Soils data provided by USDA and NRCS.

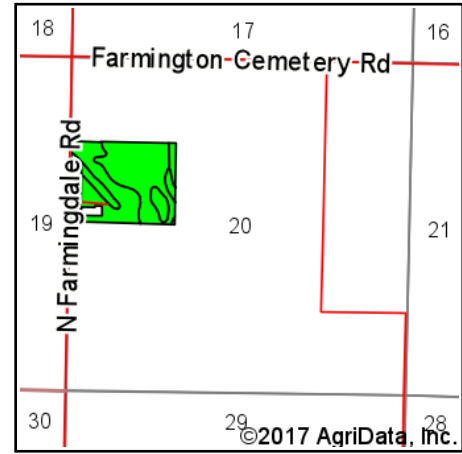

State: **Illinois**
 County: **Sangamon**
 Location: **20-16N-6W**
 Township: **Gardner**
 Acres: **44.15**
 Date: **7/28/2017**



Area Symbol: IL167, Soil Area Version: 9

Code	Soil Description	Acres	Percent of field	Il. State Productivity Index Legend	Corn Bu/A	Soybeans Bu/A	Crop productivity index for optimum management
43A	Ipava silt loam, 0 to 2 percent slopes	21.02	47.6%		191	62	142
**86B	Osco silt loam, 2 to 5 percent slopes	16.66	37.7%		**189	**59	**140
**86C2	Osco silt loam, 5 to 10 percent slopes, eroded	4.31	9.8%		**178	**56	**131
**705B	Buckhart silt loam, 2 to 5 percent slopes	2.16	4.9%		**188	**60	**141
Weighted Average					188.8	60.2	140.1

Table: Optimum Crop Productivity Ratings for Illinois Soil by K.R. Olson and J.M. Lang, Office of Research, ACES, University of Illinois at Champaign-Urbana. Version: 1/2/2012 Amended Table S2 B811

Crop yields and productivity indices for optimum management (B811) are maintained at the following NRES web site:
<https://www.ideals.illinois.edu/handle/2142/1027/>

** Indexes adjusted for slope and erosion according to Bulletin 811 Table S3

Soils data provided by USDA and NRCS. Soils data provided by University of Illinois at Champaign-Urbana.

*c: Using Capabilities Class Dominant Condition Aggregation Method