

# Krell 77.31 tax bill acres for sale - Agrivest, Inc. (217) 241-1106

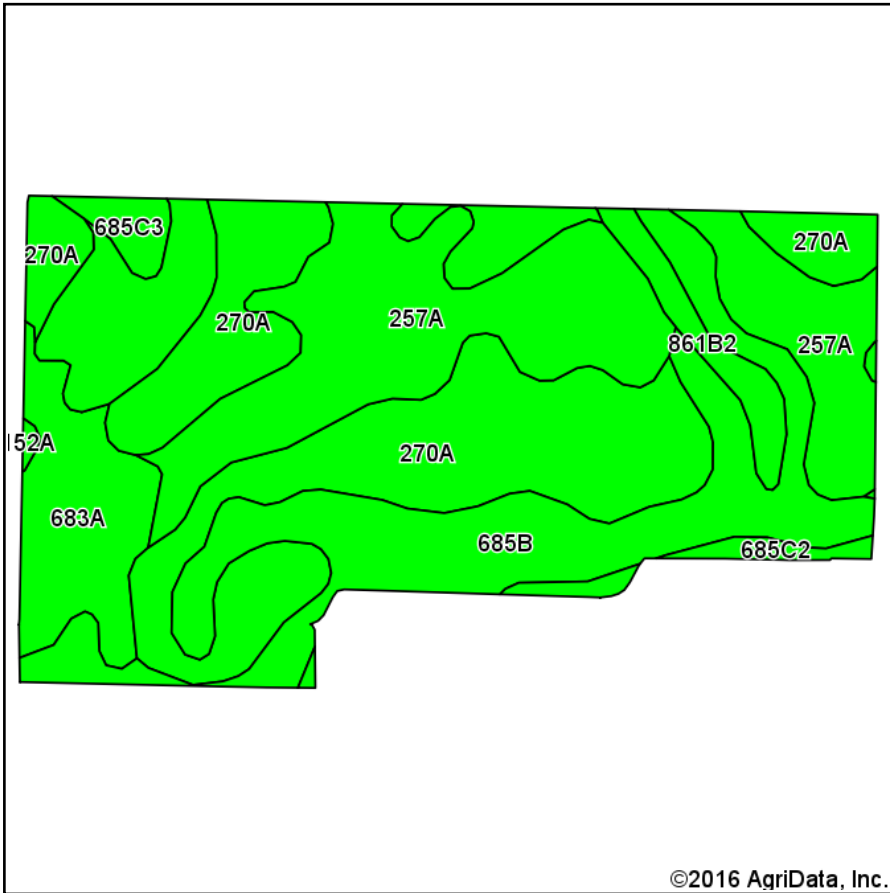

Soils data provided by USDA and NRCS.

©2016 AgriData, Inc.

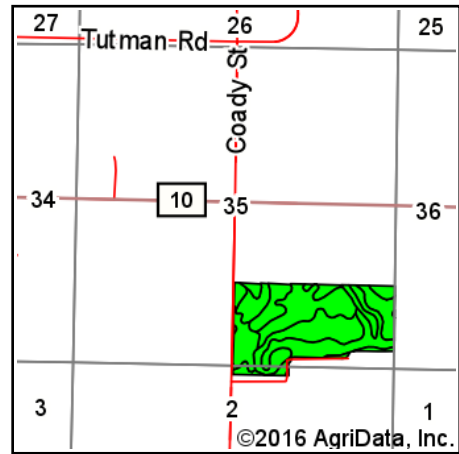

State: **Illinois**  
 County: **Menard**  
 Location: **35-19N-5W**  
 Township: **Irish Grove No. 4**  
 Acres: **77.31**  
 Date: **11/22/2016**



© AgriData, Inc. 2016 www.AgrIDataInc.com



## Area Symbol: IL129, Soil Area Version: 9

Code	Soil Description	Acres	Percent of field	Il. State Productivity Index Legend	Corn Bu/A	Soybeans Bu/A	Crop productivity index for optimum management
270A	Stronghurst silt loam, sandy substratum, 0 to 2 percent slopes	25.81	33.4%		171	53	125
**685B	Middletown silt loam, 2 to 5 percent slopes	20.67	26.7%		**160	**49	**116
257A	Clarksdale silt loam, 0 to 2 percent slopes	19.73	25.5%		174	56	128
683A	Lawndale silt loam, 0 to 2 percent slopes	6.43	8.3%		197	62	144
**861B2	Princeton-Bloomfield fine sands, 1 to 7 percent slopes, eroded	2.16	2.8%		**108	**37	**82
**685C2	Middletown silt loam, 5 to 10 percent slopes, eroded	1.25	1.6%		**151	**46	**109
**685C3	Middletown silty clay loam, 5 to 10 percent slopes, severely eroded	1.14	1.5%		**139	**42	**101
152A	Drummer silty clay loam, 0 to 2 percent slopes	0.12	0.2%		195	63	144
<b>Weighted Average</b>					<b>168.5</b>	<b>52.7</b>	<b>123.2</b>

Area Symbol: IL129, Soil Area Version: 9

**Table: Optimum Crop Productivity Ratings for Illinois Soil by K.R. Olson and J.M. Lang, Office of Research, ACES, University of Illinois at Champaign-Urbana.** Version: 1/2/2012 Amended Table S2 B811

Crop yields and productivity indices for optimum management (B811) are maintained at the following NRES web site:  
<https://www.ideals.illinois.edu/handle/2142/1027/>

\*\* Indexes adjusted for slope and erosion according to Bulletin 811 Table S3

Soils data provided by USDA and NRCS. Soils data provided by University of Illinois at Champaign-Urbana.

\*c: Using Capabilities Class Dominant Condition Aggregation Method